

## FAST REEVE CRANE BLOCKS

## 4 SHEAVES

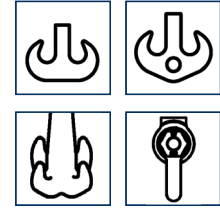
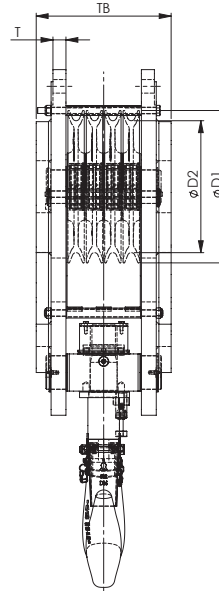
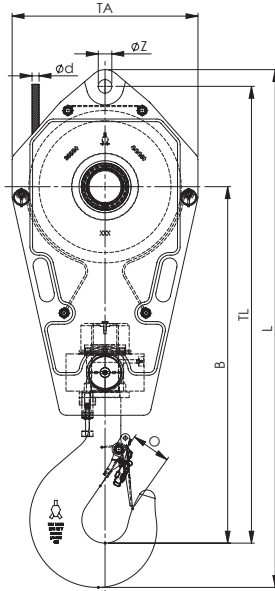

- Ramshorn hook
- Ramshorn hook form B
- Quad hook
- Shackle stud eye

Model Nr.	WLL (Mtons)	For wire ød (mm)	Hook size	Dimensions (mm)										Weight (kg)
				øD1	øD2	B	O	TA	TB	TL	L	T	øZ	
FRB 285.16.4.35.E	35	16	12	320	285	753	84	420	292	1053	1171	28	32	275
FRB 355.19.4.50.E	50	19	12	410	355	959	84	500	363	1229	1347	35	37	500
FRB 355.19.4.63.E	63	19	16	410	355	1038	97	500	343	1308	1440	35	37	570
FRB 400.22.4.63.E	63	22	16	460	400	1038	97	570	350	1333	1465	40	43	540
FRB 450.22.4.63.E	63	22	16	515	450	1038	97	600	400	1448	1580	40	43	750
FRB 450.24.4.63.E	63	24	16	515	450	1038	97	600	400	1448	1580	45	52	750
FRB 450.24.4.80.E	80	24	20	515	450	1183	110	600	527	1568	1718	45	52	1000
FRB 450.26.4.80.E	80	26	20	515	450	1183	110	600	527	1568	1718	40	52	1000
FRB 528.24.4.80.E	80	24	20	595	528	1272	110	710	527	1736	1886	45	52	1000
FRB 528.26.4.80.E	80	26	20	595	528	1272	110	710	527	1736	1886	45	52	1000
FRB 528.26.4.100.E	100	26	25	595	528	1288	132	710	472	1743	1913	40	52	1270
FRB 528.28.4.80.E	80	28	20	595	528	1273	110	710	472	1671	1821	40	59	1270
FRB 528.28.4.100.E	100	28	25	595	528	1288	132	710	472	1753	1923	40	59	1270
FRB 575.28.4.125.E	125	28	32	650	575	1413	137	770	442	1893	2083	40	59	1360
FRB 670.28.4.160.E	160	28	40	760	670	1616	167	870	662	2181	2393	50	59	3150
FRB 670.32.4.160.E	160	32	40	760	670	1616	167	870	662	2181	2393	60	66	3150

Minimum Ultimate Strength = 4 x WLL

- The dimensions in this table are indicative only. A drawing will always be submitted prior to production and will be the leading document when discussing dimensions.
- Blocks shown here are standard models; inquiries for custom versions are welcome.
- Refer to wire rope manufacturers D/d ratio guideline.
- Optional: Hook locking pin.



SEE OUR WARNING & SAFETY INFORMATION